

# BUILT FOR ROUGH TERRAIN

Enforcer Rough Terrain Forklift  
2.5 Tonne / 3.5 Tonne



- ✓ *5 Year Parts & Labour Warranty*
- ✓ *Over 500 Enforcer customers around Australia*
- ✓ *National support & spare parts*
- ✓ *Enforcer is 100% Australian owned*
- ✓ *Fastest growing Australian forklift brand*



**1300 42 3675**  
4 A FORK



**ENFORCER**

**ENFORCER**

The Enforcer 2.5T and 3.5T Rough Terrain Forklift is built with an emphasis on performance, reliability and state of the art design. Its modern design and compact size allows for better forward, side and rear visibility for the operator.

The short wheelbase provides tight turning radius to manoeuvre in limited space environments.

The Enforcer rough terrain forklift has high ground clearance, tremendous mobility and stability on rough terrain with or without load. Specifically designed for the construction, mining, forestry, lumber and building industries.

The rugged, one piece frame is welded for maximum rigidity, superior quality and long term endurance to meet the most demanding operating conditions.

## Features

- ✓ Reliable diesel Yanmar 4 TNE98 (EUIII) engine
- ✓ Superior full floating safeguard.
- ✓ Productive transmission with limited slip differential
- ✓ Maximum mast tilt angle F/R 10° / 12°
- ✓ Special wide view mast
- ✓ Over 250mm ground clearance



# Enforcer Rough Terrain Forklift Overview

## Excellent Power, Reliable Performance & Quality Components

### Two-Wheel Drive System

The Enforcer rough terrain forklift is a tough, compact forklift based on a conventional forklift, with a two-wheel drive system but built for rough terrain performance.



#### YANMAR

Type:WE3  
Model:4TNE98(EuIII/EPAIII)  
Rated output:42.1kw/2300rpm  
Rated torque:186-206N·m/1700rpm  
No. of cylinder:4  
Bore×Stroke:98×110mm  
Displacement:3.318L

### Engine

The Enforcer rough terrain forklifts are built around a Yanmar 4TNE98 (EUIII) diesel engine. Yanmar engines are world renowned for superior performance, economy and longevity.

Timed glow plug cold start for cold climates allows faster warm up and fuel savings. The Yanmar engine meets and exceeds all world environmental EPA standards.

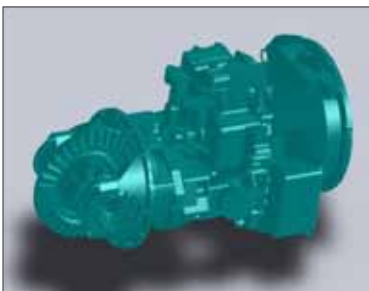

### Transmission with Limited Slip Differential

Power shift transmission with torque converter features two pedal inching, brake control and full reversal allowing faster cycle times.

The differential is specifically designed for rough terrain and features automatic limited slip differential while providing reliable ultimate traction during serious weather conditions and rough operating surfaces.



### Steer Axle

An oscillating steer axle allows either wheel to step over obstacles keeping the machine and load level. Floatation drive and steer tyres provide excellent traction and stability.

The steering angle is from 54° to 78° with very small turning radius.



### Modern Design

The Enforcer rough terrain forklift design has integrated a modern streamline design of the Enforcer counter balance forklifts and coupled it with a durable one piece, robotically welded frame for durability.



## Floating System: Less Vibration & Greater Comfort

The Enforcer rough terrain forklift adopts a floating F.O.P system and has integrated the latest in ergonomic design for operator comfort. A superior full floating operator cabin is installed with rubber damping instead of the traditional rigid design. This greatly reduces machine vibration offering a smoother ride over rough terrain and reduces operator fatigue.

Operator travel and hydraulic controls are positioned forward for most ergonomic natural operation.

Fully adjustable tilt steering wheel and suspension seat with seat belt accommodates all size operators.



## Manoeuvrability: High Ground Clearance

✓ 2.5T Over 250mm ground clearance

High ground clearance offers greater manoeuvrability and keeps the machine moving in even the roughest of applications.



## Tyres: High Quality & Durable

Enforcer rough terrain forklift front tyres are a special heavy truck tyre with a wide footprint giving you greater stability and lift capacity in rough work environments.



## Mast: Wide View & Durable

✓ Maximum mast tilt angle F/R reaches to 10° / 12°

The wide-view mast provides excellent through-the-mast visibility improving work efficiency and allowing safe operation of the forklift.

I beam rails and heavy tie bar construction reduce twisting while handling long, lateral loads on rough surface applications.

Seated bearing load rollers are externally adjustable to compensate for long term wear.

Side thrust rollers on top and bottom of mast channels and carriage side thrust rollers reduce mast roller maintenance and wear.



A clear view of the forks and surrounding area offers excellent rear view visibility is enhanced with the sloping counterweight and rear guards.

The dash and LED monitor panel is mounted low and in line of sight for operator convenience.

# Load Chart

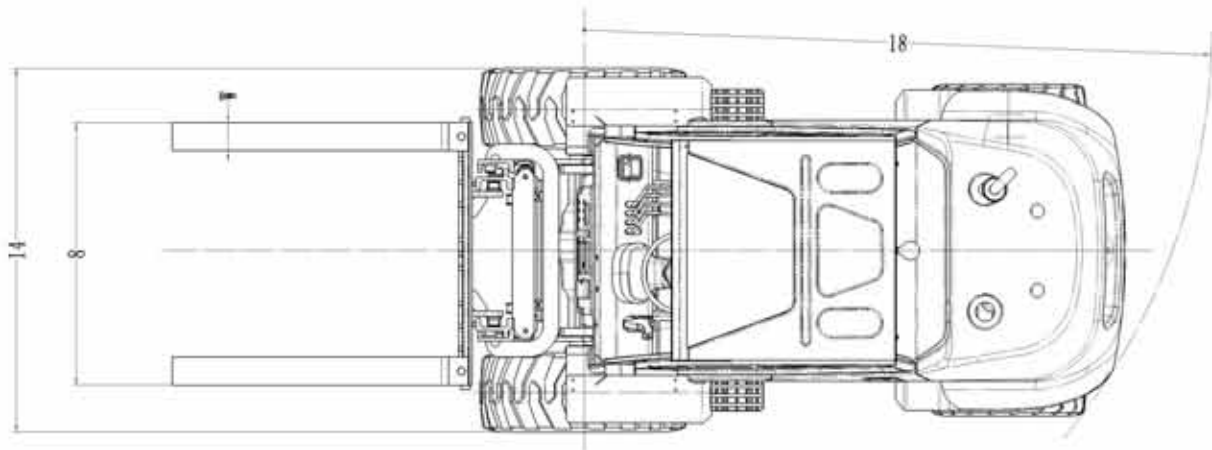
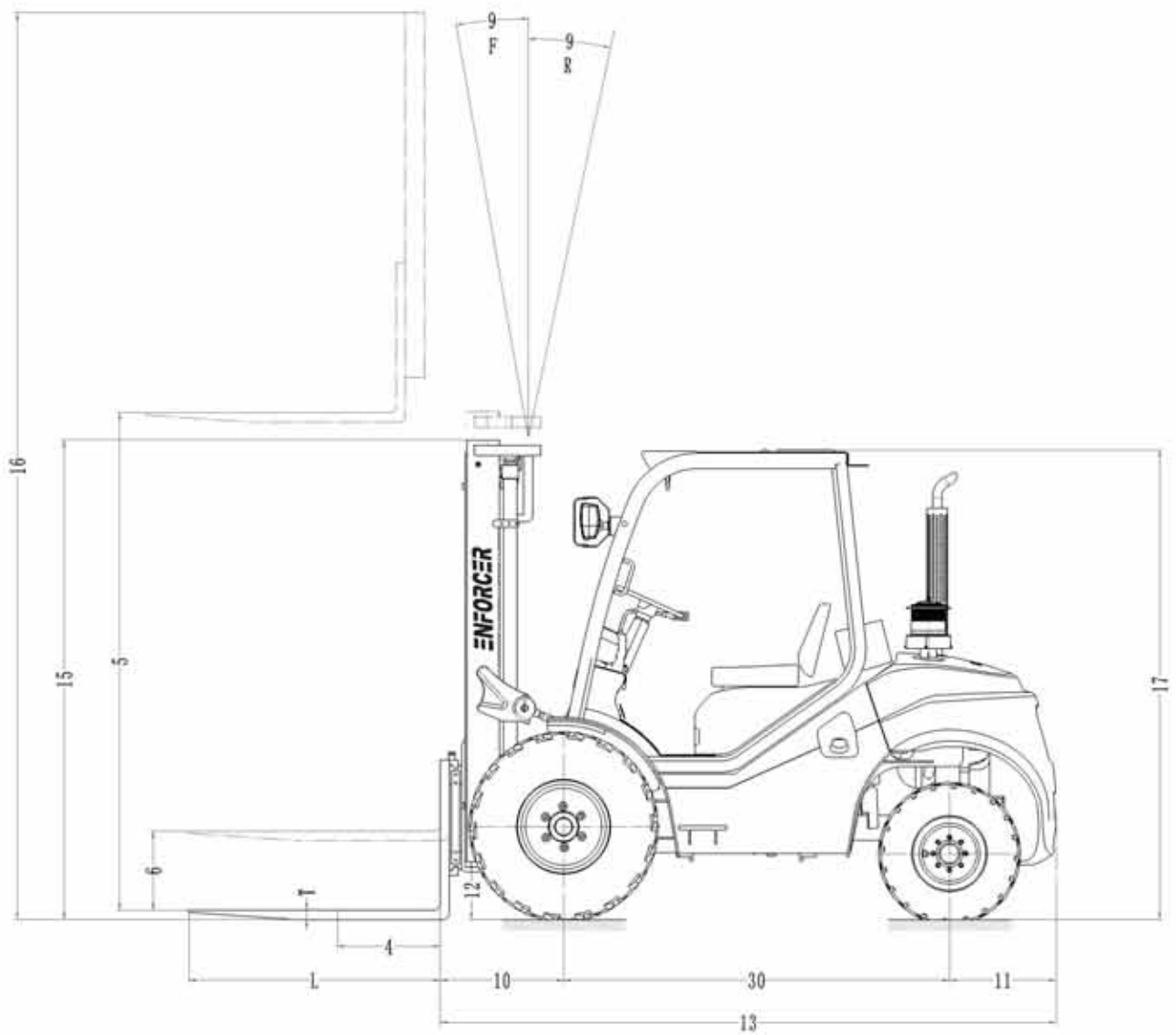

# Specification

Rough terrain diesel forklift							
General	1	Model		FD25T-CWE3	FD35T-CWE3		
	2	Power type		Diesel			
	3	Rated capacity		Kg	2500 3500		
	4	Load centre		mm	500		
Characteristic&Dimension	5	Lift height		mm	3000		
	6	Free lift height		mm	160 165		
	7	Fork size	L×W×T	mm	1100x122x40 1220x122x40		
	8	Fork regulating range	Min./Max.	mm	250-1160		
	9	Mast tilt angle	F/R	Deg	10°/12°		
	10	Front overhang		mm	586 601		
	11	Rear overhang		mm	520		
	12	Min. ground clearance		mm	270		
	14	Overall dimensions	Length to face of fork (without fork)		mm	2946 2956	
	15		Overall width		mm	1557.5 1600.5	
	16		Mast lowered height		mm	2265 2330	
	17		Mast extended height (with backrest)		mm	4175 4305	
18	Overhead guard height		mm	2256.5 2276			
19	Turning radius(outside)		mm	2783			
20	Min. right angle stacking aisle width (add load length and clearance)		mm	4795 4805			
Performance	21	Speed	Travel(Unladen/Laden)		Km/h	20/18 22/22	
	22		Lifting(Unladen/Laden)		mm/s	600/570 480/450	
	23		Lowering(Unladen/Laden)		mm/s	420/445 400/500	
	24	Max. Drawbar pull(Laden/unladen)		KN	17000		
	25	Max. Gradeability(Loaden)		%	20 16		
Tyre	26	Tyre	Front		12-16.5-14PR 14-17.5-14PR		
			Rear		27×10-12-12PR 27×10-12-12PR		
	27	Tread	Front		mm	1250.5	
			Rear		mm	1205	
	28	Tyre pressure	Front		bar	680 680	
			Rear		bar	650 650	
29	Seat to ceiling inside height		mm	1010			
30	Wheelbase		mm	1880			
Weight	31	Self weight		kg	4465 5180		
	32	Weight Distribution	Laden	Front Axle		kg	5990 7725
	33			Rear Axle		kg	975 955
	34		Unladen	Front Axle		kg	1785 2070
	35			Rear Axle		kg	2680 3110
Power&Transmission	36	Battery	Voltage/Capacity		V/Ah	12/90 12/90	
	37	Engine	Model		4TNE98-BQFLC		
	38		Manufacture		YANMAR		
	39		Rated output/r.p.m.		Kw	42.1/2300	
	40		Rated torque/r.p.m.		N.m	186-206/1700	
	41		No. of cylinder		4		
	42		Bore×Stroke		mm	98×110	
	43		Displacement		L	3.318	
	44		Fuel tank capacity		L	55	
	45	Transmission	Manufacture		China		
	46		Type		YQXD30-XH	YQXD40MKS-XH	
	47		Stage	F/R		1/1	
	48	Operating pressure(For attachments)		Mpa	20		
49	Min. right angle stacking aisle width		mm	2615			